



# FRIENDS OF THE PELLA COMMUNITY CENTER

P.O. Box 524  
Pella, Iowa 50219



# THE HEART OF PELLA

A TREASURE FROM OUR PAST  
A RESOURCE FOR OUR FUTURE



# FIRST THANK YOU FOR CONSIDERING US!

Dear Friends,

The Pella Community Center has faithfully served Pella for over 100 years, growing and evolving as the needs of the community have changed. From its start as the city's first High School, its transition to the first Middle School, and its evolution into the Community Center, it has played an important role for generations of families in Pella. However, the building itself is now in need of updates and renovations that will ensure it can serve future generations.

In the fall of 2022 the City of Pella, along with both of Pella's major corporations, committed significant support in their Facilities Upgrade project for a basic renovation of the building. The Mayor also appointed a committee representing locally involved organizations to review current and future uses of the facility. They met with an architect and the city staff during the spring of 2023 and received enthusiastically positive public input from a public meeting and an online survey.

The committee presented their recommendations to the City Council in the fall of 2023: a Base plan for \$6.3 Million that would replace or upgrade most of the building's internal systems and improve the building's accessibility and safety, and a Base Plus plan for an additional \$2 Million in private funding that would dramatically improve the new main entrance into the facility, provide new publicly accessible restrooms, and reorganize the building's layout to provide more flexible and dedicated programming space. Details for both plans are available in our casebook and on our website at [www.friendsofthepellacommunitycenter.org](http://www.friendsofthepellacommunitycenter.org), or you can use the QR code at the bottom of this letter.

The Friends of the Pella Community Center are partnering with the City to raise funds for the Base Plus plan. The amount raised will determine which elements of the Base Plus plan will be included in the final project.

We ask you to join us in preserving this treasure from our past and resource for our future. We are a recognized 501(c)3 Public Charity and can accept matching funds, RMD's and securities. Donations and pledges over five years can be made at our website or sent directly to P.O. Box 524, Pella, IA 50219. You can also contact our treasurer, Arvin Van Zante, at (641) 780-8190 if you have any questions.

Sincerely,

**Patricia VanZante, Board President**

Friends of the Pella Community Center

**"We can't underestimate the importance of the arts and culture in the life of our community. The programs made possible by our Community Center expand our horizons and support a high quality of life for Pella residents."**

Don DeWaard, Mayor of Pella, February 2020



## OUR MISSION

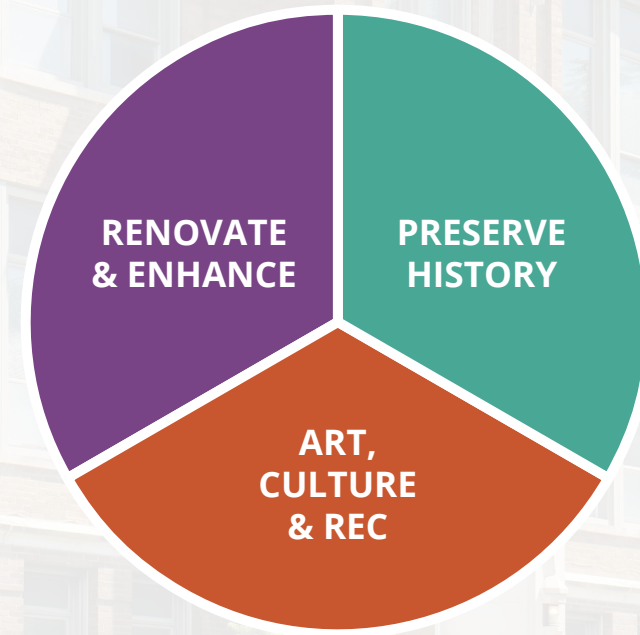

The Pella Community Center is a partner with numerous organizations throughout the community that use the facilities and engage in the provided programming.

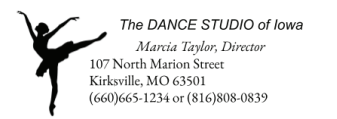
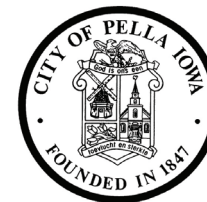



THE PELLA COMMUNITY CENTER HOSTED IN 2019 OVER 33,000 PEOPLE ANNUALLY, PLUS 1,000 SMALL GROUP RENTALS.

# 4 | FROM EDUCATION TO COMMUNITY

The Pella Community Center facility has been an asset to Pella for more than 100 years, serving as:

- A **School** that taught our parents and grandparents and was a cornerstone of the community
- An **Auditorium** that hosts quality theatre performances, cultural, and civic experiences for our citizens
- An **Art Center** that is open to the public and has available classes that range from painting to sculpting
- A **Heritage Gym** that provides non-competitive recreation space for families, groups, and open gym use
- A **Social Service Provider** through the Crossroads of Pella, which assists community members in many different ways
- A **Community Partner**, owned by the City, housing the Parks & Rec office as well as allowing community and library programs to use the facilities



**11,500**  
+ **2,500\*** **CROSSROADS**



**12,000\*\***  
+ **240** **FARVER AUDITORIUM**



**800**  
+ **210** **COMMUNITY SERVICES**



**650**  
+ **390** **ART CENTER**



**8,500**  
+ **370** **HERITAGE GYM**

**RED NUMBERS =**  
Individual Youth or Adults

**GREEN NUMBERS =**  
Group Rentals/Private Parties

\* Klompen Classic Participants  
\*\* USP Productions Participants/Audience



1936

EXPANSION  
\$60,000

1962

BECOMES JUNIOR  
HIGH SCHOOL



1985

SOCIAL SERVICES  
COMPLEX  
\$80,000

2020

HEART OF THE CITY, \$15 MILLION  
PLACED ON THE NATIONAL  
REGISTER OF HISTORICAL PLACES

1916

PELLA HIGH  
SCHOOL OPENS

1954

ADDITION  
\$45,000



1978

BECOMES PELLA  
COMMUNITY CENTER  
\$380,000

1989

AUDITORIUM  
PROJECT  
\$438,000



2024

RENOVATE  
FRONT  
ENTRANCE



# 6 | CHALLENGES

## AT OUR CURRENT BUILDING



INEFFICIENT MEETING SPACES & FLOORPLAN



OUTDATED & LIMITED TECHNOLOGY



INADEQUATE ACCESS & SAFETY FEATURES

### IDENTIFIED COMMUNITY NEEDS BASED ON PUBLIC INPUT

EXPANDED PROGRAMMING

IMPROVED ACCESSIBILITY

DINING HALL & KITCHEN

NON-COMPETITIVE RECREATION FACILITIES



In our current facility, our guests in wheelchairs can only access the gymnasium via a small landing in the upper corner.



“The Pella Preservation Trust has had a long relationship with the Community Center. The building has some of the most diverse history within the community and has a long history of service. It would be a waste to see it disappear.”  
— Bruce Boertje

“The Pella Community Center is a historic landmark that has helped generations of people find their way in life through education, art, drama, music, counseling and community events. We should not cast aside this historic treasure, one that we can never replace. This amazing building which is located in the heart of our community should be renovated and restored so it will continue to inspire generations to come. Renovation and restoration is our obligation.”

**Lynn Hinga Branderhorst**  
City Council Ward 1

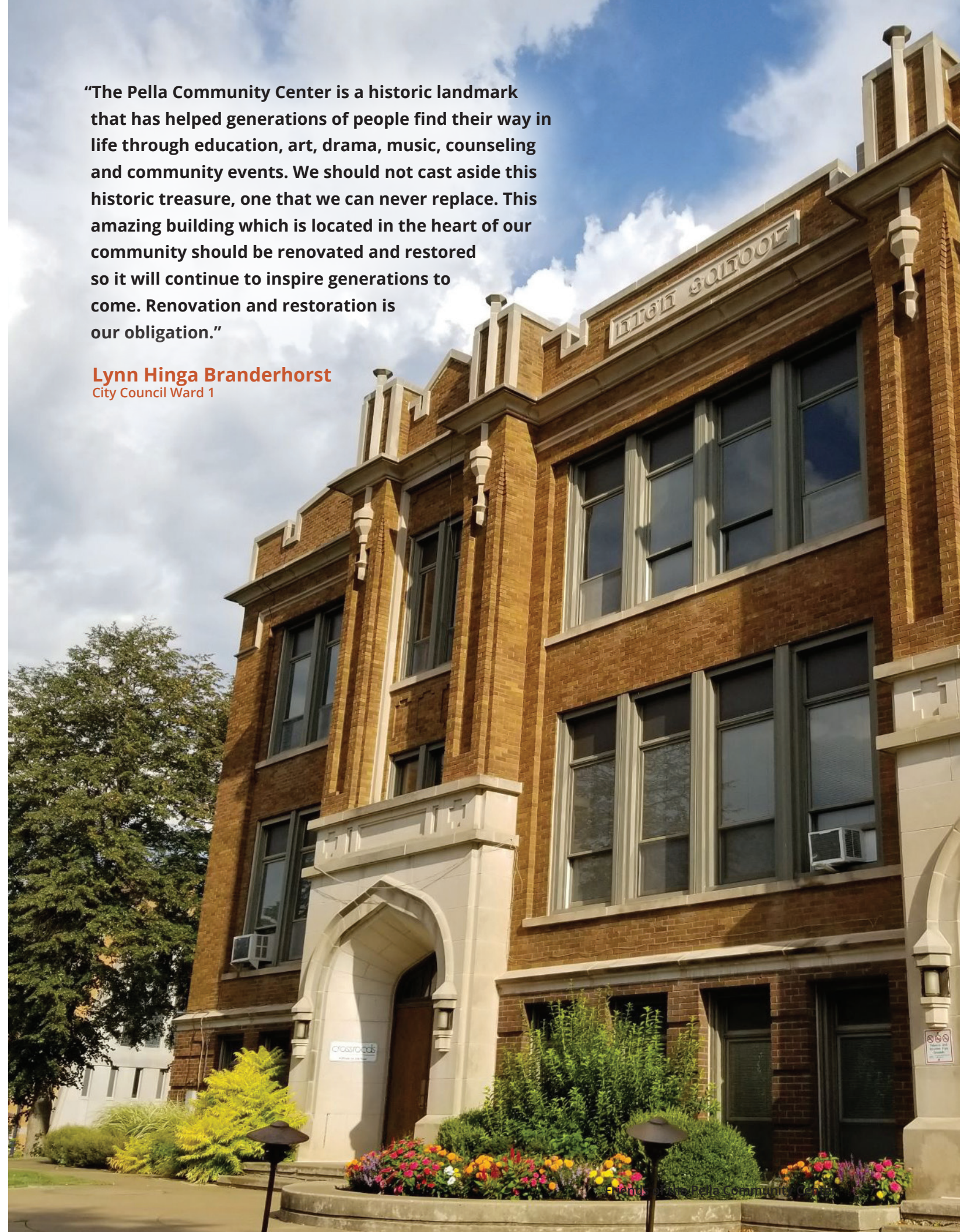



# 8 | BASE PLAN

**\$6.3 MILLION** (ESTIMATED COST)

INCLUDED IN THE CITY OF PELLA'S FACILITIES UPGRADE PROJECT



### REPLACE/UPGRADE MECHANICAL SYSTEMS:

- Replace the HVAC system
- Replace electrical and plumbing where necessary
- Replace windows where necessary
- Install fire protection

### INTERIOR REMODELING:

- Reopen the Heritage gym
- Install a LULA for wheelchair access to the gym
- Reorganize the south side of the first floor

### RELOCATE MAIN ENTRANCE:

- Relocate the main building entrance to the SE corner (current elevator entrance)
- Relocate the Community Services offices to the new SE entrance
- Create an ADA-compliant entrance ramp
- Consolidate and upgrade second floor restrooms
- Relocate Community Theater rooms to behind auditorium

# 9 | BASE PLAN+

**ADDITIONAL \$2 MILLION** (TO BE FUNDRAISED)

BASE PLAN+ INCLUDES ALL FEATURES OF THE BASE PLAN



The following features will be implemented as fundraising allows:

### ENHANCED MAIN ENTRANCE:

- New, full-sized ADA compliant elevator with access to all four floors
- New stairs with access to all four floors (including the gym)
- New publicly available restrooms
- Provides better visibility and control over access to the building

### INTERIOR REMODELING:

- Remove old SE stairway to provide more programming space
- Expand and upgrade all existing restrooms
- Install certified kitchen for public use and cooking classes
- Create more flex spaces



# 10 | FLOOR PLANS

## 1<sup>ST</sup> FLOOR



Community Service Relocation

New ADA-Compliant Entrance Ramp and Access to Gym Floor

## GROUND FLOOR



## 2<sup>ND</sup> FLOOR



Certified Kitchen

Restroom remodel

Flex space

## 3<sup>RD</sup> FLOOR

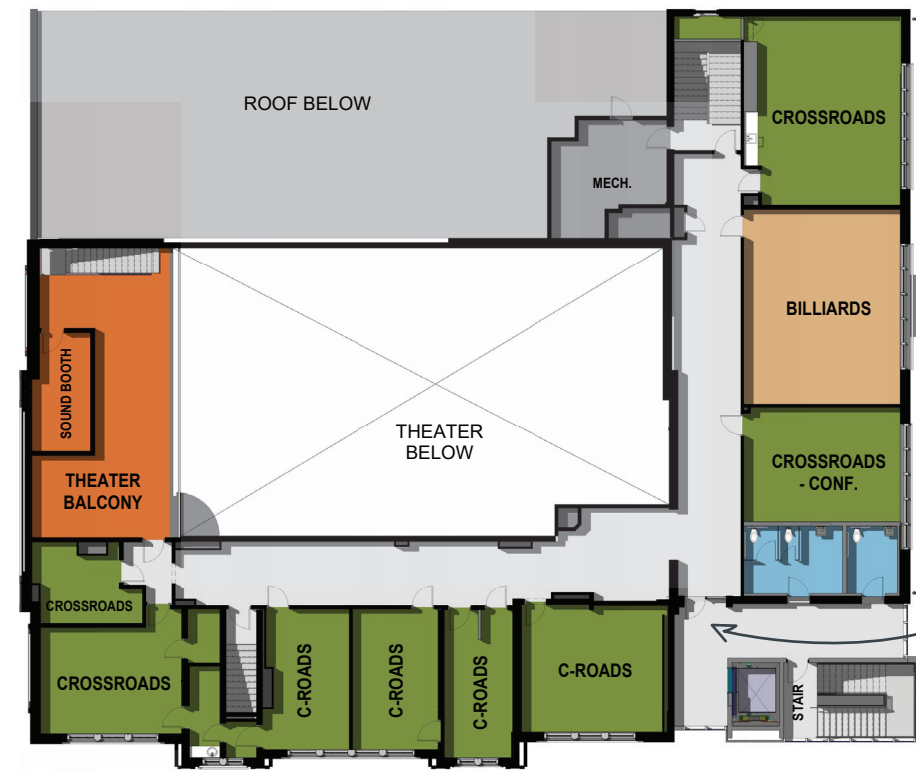

Additional interior remodeling and deferred maintenance



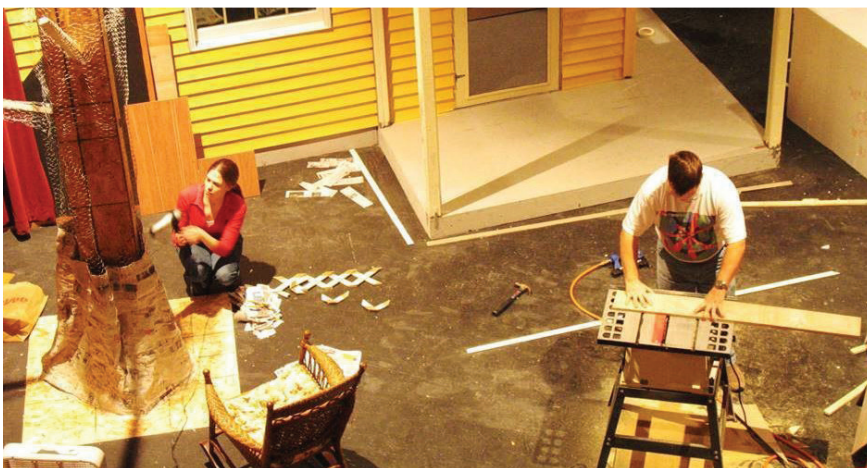

## BOARD MEMBERS

Pati VanZante, President  
 Rhonda Kermode, Vice President  
 Duane Rempe, Secretary  
 Arvin Van Zante, Treasurer  
 Bruce Boertje  
 Jim Hibma  
 Chris Allen  
 Wayne Steinstra  
 Dorian Goodyk  
 Jeanette Vaughan, City Ex Officio  
 Bruce Haustein, Emeritus  
 Davis & Eunice Folkerts, Emeritus  
 Robin Martin, Emeritus  
 Michelle Jones, Emeritus



VAN WYK CREATIVE | [vanwykcreative.com](http://vanwykcreative.com)  
[bailey@vanwykcreative.com](mailto:bailey@vanwykcreative.com) | 641-780-6717